



Brickfield Road, Clapham, SW4

2 bedroom flat - purpose built for sale

£465,000

Leasehold

Property Details

This stunning two-double-bedroom, two-bathroom apartment boasts a private terrace and a modern, open-plan layout. The spacious reception and dining area is ideal for both relaxation and entertaining, with the lounge flowing seamlessly onto a terrace, perfect for alfresco dining or enjoying the sunshine. Adjacent storage cupboards help keep the space organised and clutter-free. The kitchen is defined with tiled flooring and features sleek white cabinetry with dark worktops, integrated appliances, and a window providing natural light and ventilation. The principal bedroom offers direct terrace access, a storage cupboard, and a contemporary ensuite with a shower cubicle, creating a peaceful private retreat. The second bedroom is a comfortable double, perfect for guests, a home office, or a versatile space to suit your needs. The main bathroom is generously proportioned with a shower over the bath, finished in neutral tones.

Features

- Two double bedrooms
- Two bathrooms
- Private terrace
- Over 800 square feet
- Secure modern development
- Local shops and amenities
- Abbeville Village and Clapham High Street nearby
- Northern line a short stroll away
- Gym less than a five-minute stroll
- Parking permits available. Chain-free

Council tax band D EPC rating (null)





Brickfield Road, Clapham, SW4

Brickfield Road, SW4
2 Bedroom Flat

APPROXIMATE GROSS INTERNAL AREA: 814 SQ FT / 75.6 SQ M

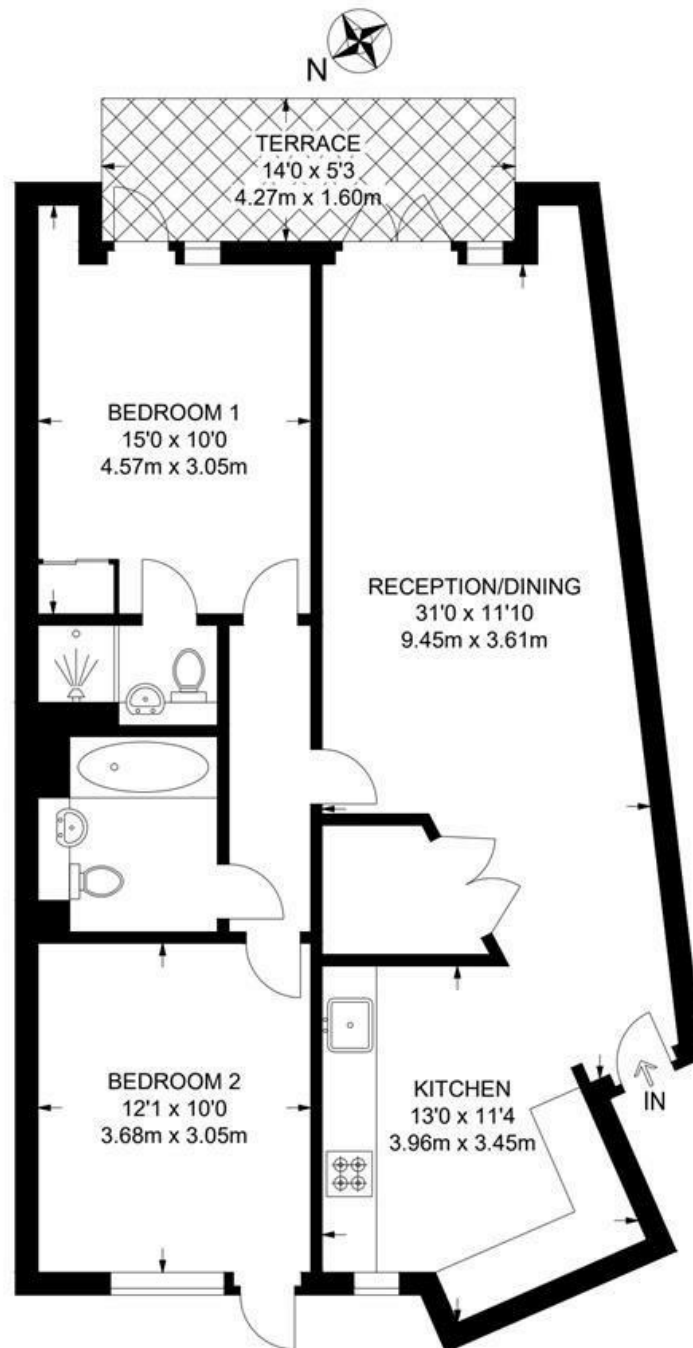

THIRD FLOOR



While we try our very best, floor plans are produced as a guide only and we take no responsibility for the precise accuracy with which any property is represented.

Brickfield Road, Clapham, SW4

